

# THERMOSTATIC MIXING VALVES

## MINIMIXing

### FOR POINT OF USE CONTROL



#### ◆PURPOSE

Specific thermostatic mixing valve for point of use control.

Designed to supply sinks, hand wash-basins or electronic faucets with immediate tempered water not exceeding a temperature set.

MiniMIXing provides high security level against scalding and Legionella bacteria.

**Ideal for multi-facility applications :** hospitals, nursing homes, hotels, schools, restaurants, laboratories, motorway services ... anywhere needing an excellent temperature management, particularly on start up of flow.

#### ◆FEATURES AND BENEFITS

- extra compact size,
- aesthetic design with brass body chrome polished,
- easily installed directly on isolating tap under basin or fixed on the wall with a plate provided in the box,
- temperature set secured by hexagonal socket screw (Allen key),
- easy to replace modular adjustment mechanism (cartridge),
- reducing maintenance service cost,
- no setting scale : temperature can be set only by installer or operator, not by user,
- fitted with 2 approved check valves (KIWA, WRC, DVGW, BELGAQUA, NF...),
- outstanding reliability,
- compliance with standard EN1111.

#### ◆SCALD PROTECTION

High level of protection from scalding : instant failsafe in case of hot or cold water failure.

#### ◆PROTECTION AGAINST LEGIONELLA

- Cartridge can be removed and replaced (for easier scale removal and disinfecting).
- Integral approved check-valves avoid connection risk between cold and hot water (withstanding temperatures above 90°C).
- Thermal shock : simply remove the protective cover and set the temperature with the Allen key to maximum hot position to allow hot water to circulate (kills bacteria above 60°C).
- The valve is delivered with a rinsing cover kit : after removed the cartridge and place the rinsing cover kit, you can flush the valves with a disinfectant solution or with a water temperature up to 90°C without danger of damaging the thermostatic mechanism.

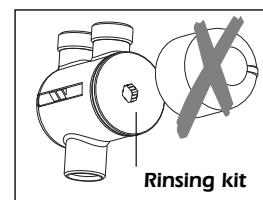
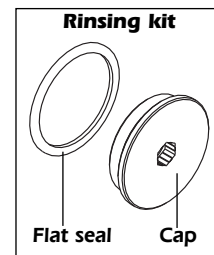

## ◆ SPECIFICATIONS

**4 models available in 2 dimensions :** 3/8" and 1/2"

**code 97320 : 3/8" (12x17) flat sealing**

- hot water Female free nut 3/8" (12x17)
- cold water Male 3/8" flat sealing (12x17)
- mixed water Male 3/8" flat sealing (12x17)

**code 97321 : 1/2" (15x21) flat sealing**

- hot water Male 1/2" flat sealing (15x21)
- cold water Male 1/2" flat sealing (15x21)
- mixed water Male 1/2" flat sealing (15x21)

**code 97322 : 3/8" (12x17) compression fitting 12 mm**

- hot water Female free nut 3/8" (12x17)
- cold water, mixed water : compression fittings 12 mm

**code 97323 : 1/2" (15x21) compression fitting 15 mm**

- hot water, cold water, mixed water : compression fitting 15 mm

## ◆ TECHNICAL FEATURES

Dynamic flow rates :

Under	1 bar	2 bar	3 bar
Flow rate in L/min	14,9	22	28

Minimum flow rate : 5 l/min

Temperature setting range : 30 to 70°C

Max inlet hot water : 85°C

Max working pressure : 10 bar

Factory set temperature : 38°C

Body : DZR brass CW602N

Cap : ABS

Thermostatic cartridge : ULTEM 1000

Nut : brass CW614N

(All materials are WRC and KTW approved)

Approval : KIWA (NL)

## ◆ DIMENSIONS

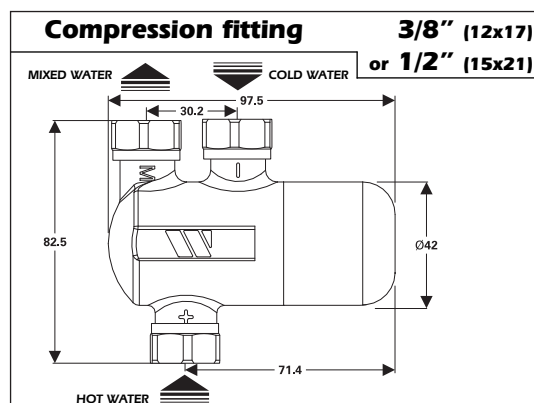
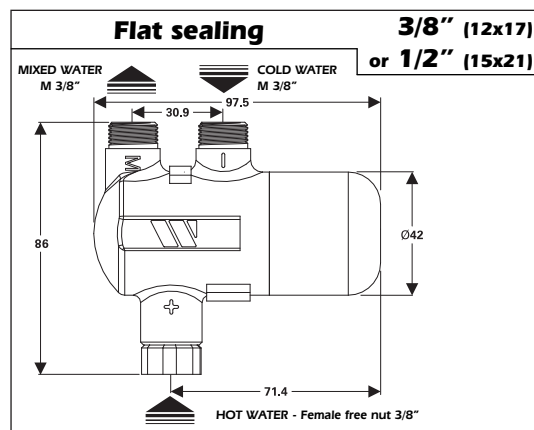

## ◆ TYPICAL INSTALLATION

Parallel to the wall

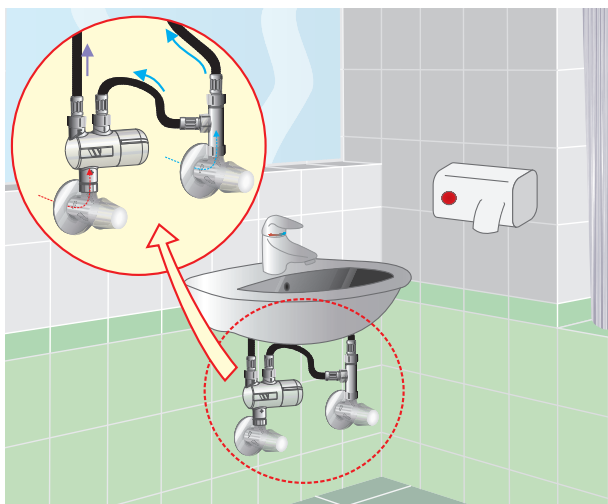

Perpendicular to the wall

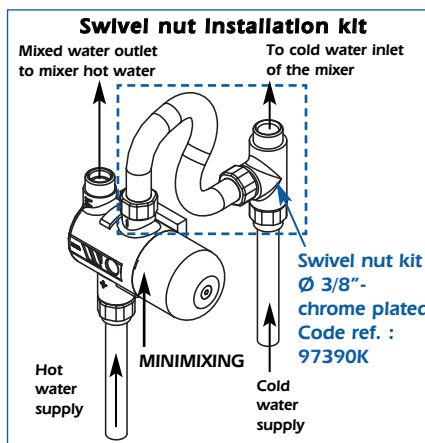
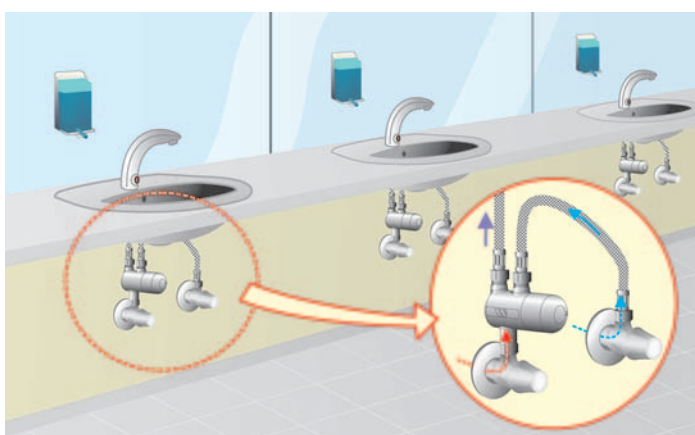

Wall plate, included in the package



## ◆ PRESSURE DROP CURVE / HEADLOSS

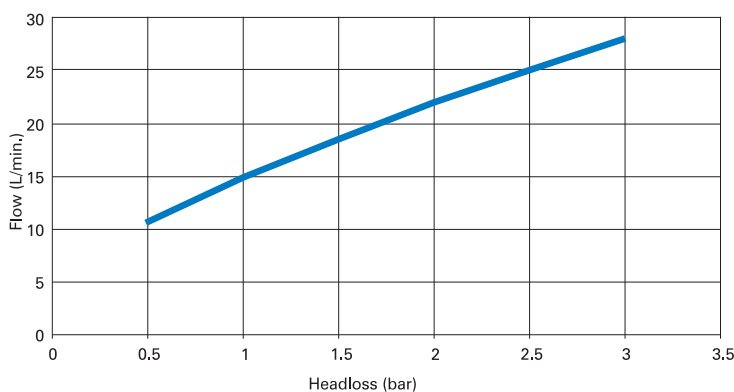

### Head office and factory

13, rue J.J. Rousseau.

B.P. 90007

80390 FRESSENNEVILLE

Tel. 03 22 60 39 80

Fax 03 22 60 39 89

### Commercial services

06, avenue Gustave Eiffel

B.P. 40339

28006 CHARTRES Cedex

Tel. 02 37 25 11 00

Fax 02 37 25 11 11

Fax 02 37 25 11 44

