

Thermostatic blending valve RLT M2

New



- L-pattern valve (considered convenient for many system configurations).
- Complies with EN1111 and EN1287 – TMV2 (with check-valves).
- Outlet temperature setting range : 25 to 55°C.
- Flow rate at 3 bar : 38 l/min. (3/4" M).
- Extra compact size.
- Integral check valves for protection against cross-flow.
- Brass DZR body.

WATTS
INDUSTRIES

A Division of Watts Water Technologies Inc.

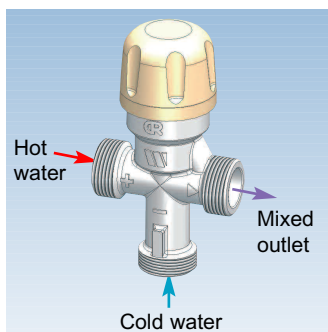
**Application :**

L-pattern thermostatic mixing valve for general purpose applications. RLT M2 is often used for safely regulating supply temperature to hand wash basins with infra red tap.

Typical hand wash basin applications could be sport halls, motorways services, domestic homes, shopping malls, or public buildings.

RLT M2 can be used also to control the temperature in a sanitary hot water distribution system for a domestic property.

Features :

- Rapid fail safe if cold water supply is interrupted comply with EN1111 and EN1287 – TMV2 (with check-valves).
- L-pattern design can aid system configuration and reduce installation time.
- Provides stable mixed water temperature.
- Tamperproof setting adjustment with free “click” cover cap.
- Integral check valves for protection against cross-flow (size Female 1/2” delivered without check-valves).
- Can be installed in any position.
- Nickel plated finish.

Diameter	Check-valves	Finish	Code ref.
Male / Male / Male 3/4"	yes	nickel plated	97009M2
Compression fitting 15 mm	yes	nickel plated	97195
Female / Female / Female 1/2"	no	nickel plated	97152

Approvals :

Wras (UK), ACS (F).

Specifications :

- G3/4" Male threaded on inlets and outlets or compression fitting 15 mm or Female 1/2".
- Pressure at the valve inlets must be within the 5:1 ratio under flow conditions.

The size and layout of pipework and in-line fittings must take this into consideration.
Optimum performance achieved with equal pressure.

- Temperature : accurate to within 1,5°C of chosen temperature (with balanced dynamic pressure).
- Head loss under dynamic pressure at the mixer inlets is shown by the curve.
- Maximum static pressure : 10 bar.
- Operating pressure : 0,2 to 5 bar.
- Hot temperature supply : 50* - 85°C, *differential minimum hot/mix temperature must be 20°C.
- Cold temperature supply : 5 - 20°C.
- Temperature setting range : 25 to 55°C.
- Factory temperature setting : 38°C.
- Flow rate at 3 bar : - 3/4"M : 38 l/min.
- 1/2"F & 15mm comp. fitting : 35 l/min.
- Flow mini : 5 l/min.
- Body strength : 25 bar.

Materials :

description	material
Body brass DZR	CW602N
Finish	nickel plated
Spring	stainless steel
Piston	PSU (polysulfone polymer)
O-ring	EPDM
Check-valve	POM, stainless steel and rubber
Head	PA with glass fiber

Dimensions :

- Male/Male/Male 3/4" : 97009M2
(flat sealing)

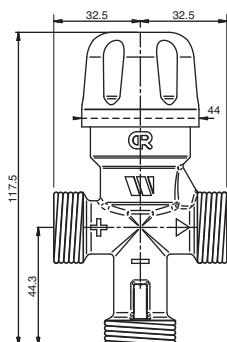

- Female/Female/Female 1/2" : 97152
(delivered without check-valves)

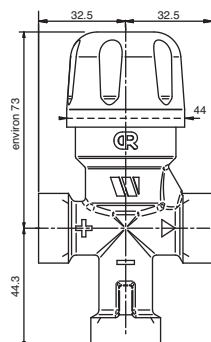

- Compression fitting 15 mm : 97195
(delivered with integral strainers)

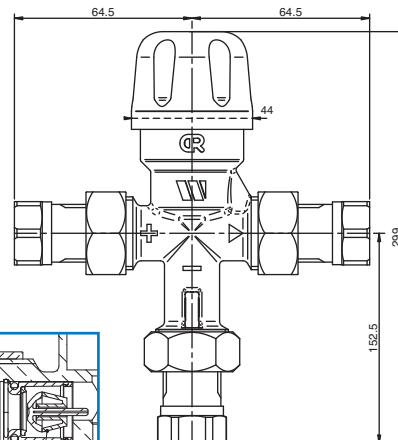
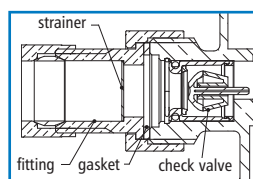

How to open the cap :

Tamperproof setting adjustment
with free "click" cover cap.

Lift under the
triangle ▲ to open.

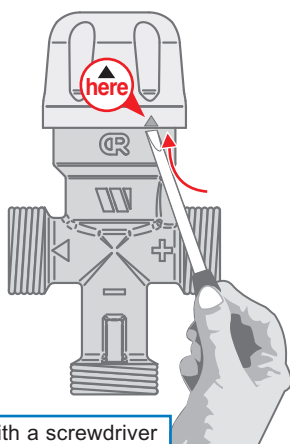
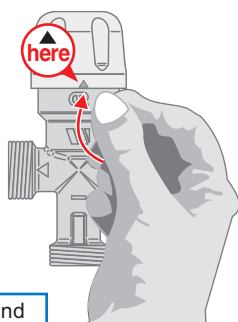

Pressure drop curve / headloss :

Female/Female/Female 1/2"

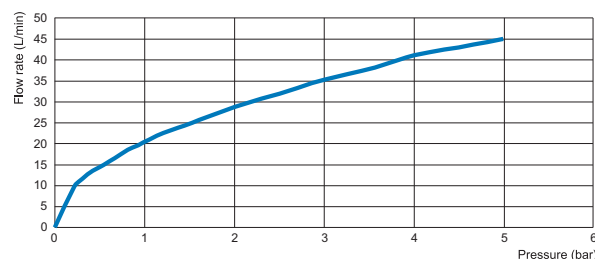

Male/Male/Male 3/4"

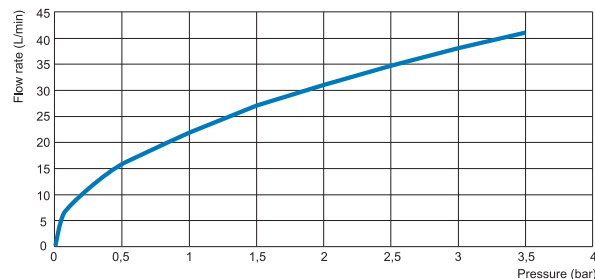

Compression fitting 15 mm

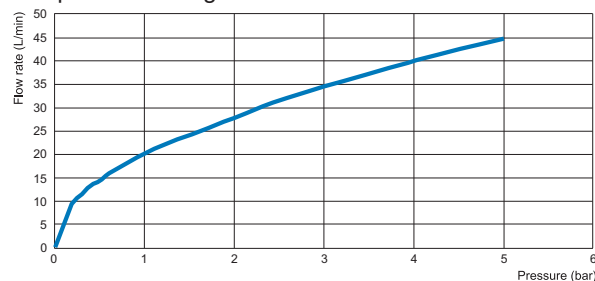

Installation & Temperature setting :

In order to maintain the valve performances, a strainer must be installed upstream on the main water supply line to eliminate the risk due to debris.

The thermostatic controller is supplied factory pre set at 38°C.

However, installation conditions may dictate, that the product be adjusted on site.

To adjust the temperature supply, simply remove the plastic cap on top of the valve.

Manipulate the axis. - To increase the temperature turn anti-clockwise.

- To decrease the temperature turn clockwise.

After adjustment, replace the cap to lock the valve in position and prevent tampering.

Typical installation :

Hand wash basin temperature control

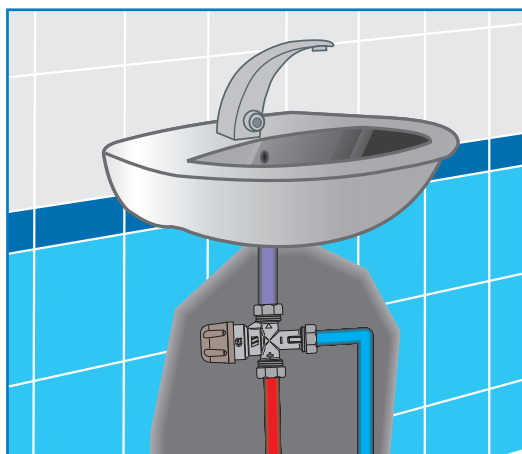

Sanitary hot water distribution control

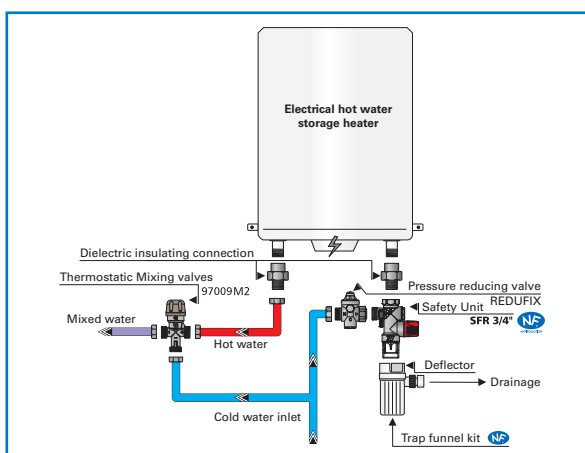

The photographs, illustrations and descriptions contained in this brochure are given for information only.
Watts Industries reserves the right to change the technical specifications or the design of these products without prior notice.



A Division of Watts Water Technologies Inc.

WATTS INDUSTRIES France

06, avenue Gustave Eiffel - B.P. 40339

28006 CHARTRES Cedex (France)

Tel. +33 (0)2 37 25 11 00 - Fax +33 (0)2 37 25 11 11

E-mail info@wattsindustries.fr

Site www.wattsindustries.com