

Thermostatic mixing valves TX91

ULTRAMIX®



For more information,
please refer to the new [click here](#)
documentation ULTRAMIX range.



- Continuous PROTECTION AGAINST LEGIONELLA.
- SCALD PROTECTION.
- MAXIMUM LIMITATION of adjustable and boltable TEMPERATURE.
- LIMITED MAINTENANCE : no friction from moving metal parts means excellent resistance to scale and remarkable longevity.
- BIMETALLIC STRIP TECHNOLOGY : exceptional qualities of regulation and resistance to the scale (crucial factor for safety).
- SIMPLE AND FAST MAINTENANCE: removal cartridge without dismantling the thermostatic mixing valve, strainers and integrated check valves  accessible directly on the cartridge.
- ADJUSTMENT PRECISION and COMFORT of the temperature stability with low and high flow rates.
- GUARANTEE : thermostatic mixing valve and cartridge guaranteed 2 years.
- Direct access to the calculation software : [click here](#)

 **WATTS**
INDUSTRIES®

A Division of Watts Water Technologies Inc.

Integrated
check-valves
and strainers



TX91 ULTRAMIX thermostatic mixing valve - 3 to 56 L/min

Built-in blocking control knob - Cover in front (gray PVC).
Standards temperature range: 10/50°C or 30/70°C,
on request and for no extra charge: 5/40°C.
Blue control knob graduated.
Dynamic pressure flow rates under 3 bar.

1 mixed water outlet on the top.
1 bottom mixed water outlet to be plugged.
Inlet hot water on the left, cold water on the right,
possibility of reversed inlets for no extra charge
(add "IN" at the end of the ref. codes).

- Anti-scalding feature : The hot water shuts off automatically if there is not enough cold water. (Δ Hot water/Mixed water > 10°C).
- Thermostatic mixing valve mechanism: the mechanism is directly integral with the thermostatic mixing valve cover.
- Approved check-valves : superior level hydraulic features, due to the valve closure member's overall design.
- Filtering : Strainer anchored on watertight elastomer support. Perfect accessibility, disassembly without tools, easy cleaning requiring no special qualification.
- Total interchangeability: the ULTRAMIX range cartridges are interchangeable with the current range and the old range.
- ULTRAMIX is guaranteed 2 years. • Rinsing kit included.

Characteristics:
The ULTRAMIX may be supply by any hot water production system, even by instantaneous production ; if the generator is able to produce very low hot water flows.

Operating pressure :

maxi.	mini.	recommended
10 bar	1 bar	2-4 bar

Max. hot water temperature: 85°C.

Minimum temperature variation between inlets : 5°C.

Maximum pressure variation: 1,5 bar.

Dynamic flows pressure:

Under	1 bar	2 bar	3 bar
Flow rate (l/min.)	24	41	56
Flow rate (l/sec.)	0,40	0,68	0,93

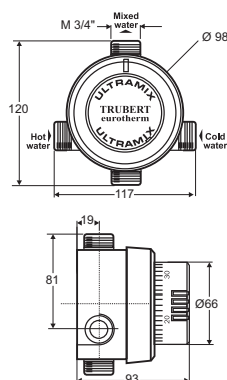

Bottom outlet to be plugged

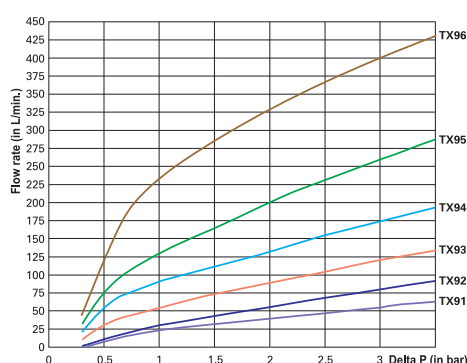

Against legionella answer:

- You can with the thermostatic mixing valve such as it is (with 30/70°C cartridge):
 - adjust the temperature up to 55°C in the primary loop (recommended temperature).
 - adjust the temperature to 39°C (until 50°C - according to uses) in the secondary loop.
 - proceed to a thermal "shock": simply by freeing the control knob and position it a 70°C (without dismantling the thermostatic mixing valve, cartridge or control knob).
- You also can by putting the cartridge in position "rinsing" i.e. turned over cartridge, fixed at back, (rinsing kit and simple procedure delivered with each ULTRAMIX) :
 - rinse the thermostatic mixing valve and the drains (important before activation).
 - inject a disinfectant (chlorine) into the water supply system without danger of damaging the thermostatic mechanism, because is not any more in contact with water.
 - proceed to a thermal "shock" with more 70°C, without risk to damage the thermostatic mechanism prematurely, because is not any more in contact with water.

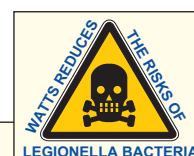

flow rate (L/min)	diameter	points of use*	adjustment range	finish	art. number	weight
mini 3 - maxi 56	M 3/4" 20x27	1 to 7	10/50°C	grey epoxy	22TX91E	1,8 kg
mini 3 - maxi 56	M 3/4" 20x27	1 to 7	10/50°C	chrome plated	22TX91C	1,8 kg
mini 3 - maxi 56	M 3/4" 20x27	1 to 7	30/70°C	grey epoxy	22TX91E37	1,8 kg
mini 3 - maxi 56	M 3/4" 20x27	1 to 7	30/70°C	chrome plated	22TX91C37	1,8 kg

- Body (chrome plated or epoxy)
- Cartridge TX1 (10/50°C) art. no. 22TX1
- Cartridge TX137 (30/70°C) art. no. 22TX137
- Blue control knob (10/50°C) art. no. 22T120705
- Blue control knob (30/70°C) art. no. 22T120706
- Fixing kit for control knob art. no. 22T120700
- Cover art. no. 22TB108250
- Complete maintenance kit art. no. 22TB120002
- Simplified maintenance kit (without screws) art. no. 22TB120022

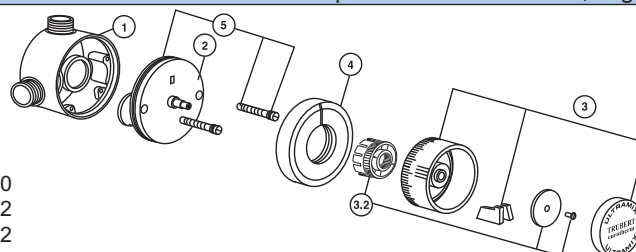

The photographs, illustrations and descriptions contained in this brochure are given for information only.
Watts Industries reserves the right to change the technical specifications or the design of these products without prior notice.